

EVERETT SCHOOL DISTRICT NO. 2

Annexation of Silver Lake Elementary School Property to the City of Everett

RESOLUTION NO. 845

A resolution of the Board of Directors of Everett School District No. 2, Snohomish County, Washington, authorizing the Superintendent to petition the City Council of the City of Everett for annexation of the Silver Lake Elementary School site to the City of Everett.

WHEREAS, the Silver Lake Elementary School site is contiguous to the current city limits of the City of Everett as a result of a recent annexation; and

WHEREAS, the Board of Directors has determined that it is in the best interests of the District to authorize the Superintendent to petition the City Council of the City of Everett for annexation of the Silver Lake Elementary school site to the City of Everett; and

WHEREAS, RCW 28A.335.110 authorizes the Board of Directors of a school district to petition for the annexation of school property to a city or town, so long as such school property constitutes the whole of such property in the annexation petition;

NOW, THEREFORE, BE IT RESOLVED by the Board of Directors of the Everett School District No. 2, Snohomish County, Washington, as follows:

Section 1. Annexation Petition

The Superintendent of the District is hereby authorized and directed to petition the City Council of the City of Everett for annexation of the Silver Lake Elementary School site to the City of Everett, so long as that site constitutes the whole of the property described in the annexation petition. The legal description of the site is attached hereto as Exhibit A. Subject to the provisions of this Section 1, the Superintendent is further authorized and directed, to style and structure the petition to accommodate, to the extent reasonably practicable and consistent with law, the annexation process preferences of City of Everett staff.

Section 2. Headings

Headings used in this resolution are for convenience of reference only and shall not affect the interpretation or construction of this resolution.

ADOPTED this 21st day of February, 2006, and authenticated by the signatures affixed below.



Roy Yates
President, Board of Directors

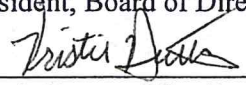

Kristie Dutton, Vice-President

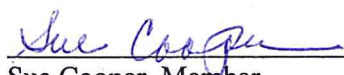

Sue Cooper, Member

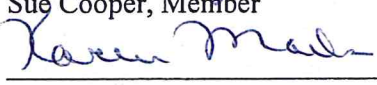

Karen Madsen, Member

ATTESTED BY:

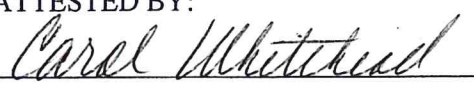

Carol Whitehead, Ed. D.
Secretary, Board of Directors

Exhibit A: Legal Description of Silver Lake Elementary School

TAX ACCOUNT #'S: 28052900303400 (EXISTING SCHOOL)
00633800000700 (RESIDENTIAL LOT)
00902200004800 (EASEMENT LOT)

EXISTING SCHOOL:

THE NORTH HALF OF THE NORTH HALF OF THE SOUTHWEST QUARTER OF THE SOUTHWEST QUARTER OF SECTION 29, TOWNSHIP 28 NORTH, RANGE 5 EAST, W.M., IN SNOHOMISH COUNTY, WASHINGTON.

TOGETHER WITH THE FOLLOWING DESCRIBED TRACT:

BEGINNING AT THE SOUTHWEST CORNER OF THE NORTHWEST QUARTER OF THE SOUTHWEST QUARTER OF SAID SECTION;
THENCE NORTH 247.5 FEET;
THENCE EAST 276 FEET;
THENCE SOUTH 247.5 FEET;
THENCE WEST 276 FEET TO THE POINT OF BEGINNING;

EXCEPT THAT PORTION THEREOF CONVEYED TO SNOHOMISH COUNTY BY DEEDS RECORDED UNDER AUDITOR'S FILE NUMBERS 144814, 144900 AND 145589;

AND EXCEPT THAT PORTION THEREOF CONVEYED TO THE STATE OF WASHINGTON BY DEED RECORDED UNDER AUDITOR'S FILE NUMBER 8612110413;

AND EXCEPT THAT PORTION THEREOF CONVEYED TO THE CITY OF EVERETT BY DEED RECORDED UNDER AUDITOR'S FILE NUMBER 200207100621;

AND EXCEPT THE FOLLOWING DESCRIBED PROPERTY:

BEGINNING AT THE NORTHEAST CORNER OF THE SOUTH 247.5 FEET OF THE WEST 276 FEET OF THE NORTHWEST QUARTER OF THE SOUTHWEST QUARTER;
THENCE NORTH 88°48'14" WEST ALONG THE NORTH LINE THEREOF 19.83 FEET;
THENCE SOUTH 00°53'24" WEST 33.20 FEET;
THENCE NORTH 89°06'36" EAST 18.90 FEET TO THE EAST LINE THEREOF;
THENCE NORTH 00°43'57" EAST ALONG SAID LINE 32.49 FEET TO THE POINT OF BEGINNING.

SITUATE IN THE COUNTY OF SNOHOMISH, STATE OF WASHINGTON.

RESIDENTIAL LOT: (ABBREVIATED)

LOT 7 OF HILLIS ADDITION TO SILVER LAKE

EASEMENT LOT: (ABBREVIATED)

LOT 48, HERSCHLIP ADDITION

NOTICE OF INTENT TO ANNEX

City Council Members
City of Everett
3002 Wetmore Ave
Everett, WA 98201

Honorable Council Members:

The undersigned, representing owners of not less than ten percent in value of the property (assessed valuation for general taxation purposes) for which annexation is proposed, hereby advises the City Council of the City of Everett that it is the desire of the undersigned representative(s) (see petition) to commence annexation proceedings for the area depicted on the attached map.

It is requested that the City Council set a date not later than sixty days after filing of the request for a meeting with the undersigned to determine:

1. Whether the City Council will approve the attempted gathering of petition signatures representing 75% of the assessed valuation of properties found within the annexation boundaries as depicted upon the attached map;
2. Whether the City Council will geographically modify the proposed annexation area boundaries;
3. Whether the City Council will require the simultaneous adoption of a comprehensive plan for the area proposed for annexation; and
4. Whether the City Council will require the assumption of existing City indebtedness by owners of property within the proposed annexation area.

Respectfully Submitted,

Name and Title

Date

10% PETITION FOR ANNEXATION TO THE CITY OF EVERETT

Signing this petition constitutes a request (NOTICE OF INTENT) to the City of Everett to give initial consideration to annexation of your property to the City of Everett (RCW 35.13.125).

The property proposed for annexation is depicted on the attached map.

It is requested that the City Council of the City of Everett set a date not later than sixty days after filing of this request for a meeting with the undersigned to determine:

- (1) Whether the Everett City Council will approve gathering of signatures on the 75% petition for annexation;
- (2) Whether the City Council will geographically modify the proposed annexation area boundaries;
- (3) Whether the City Council will require the adoption of a comprehensive plan for the area proposed for annexation; and
- (3) Whether the City Council will require the assumption of existing City indebtedness by owners of property in the area to be annexed.

SIGNATURE	PRINT NAME	ARE YOU A RESIDENT OF THE ANNEXATION AREA? (YES OR NO)	ARE YOU AN OWNER OF LAND LOCATED INSIDE THE ANNEXATION AREA? (YES OR NO)	TAX NUMBER(S) (or address)	ACRES or square feet, (if known)
1					
2					
3					
4					
5					
6					

Page _____ of _____
Date issued: _____
Date Returned: _____

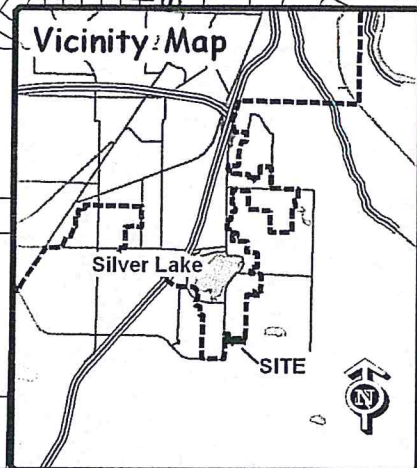
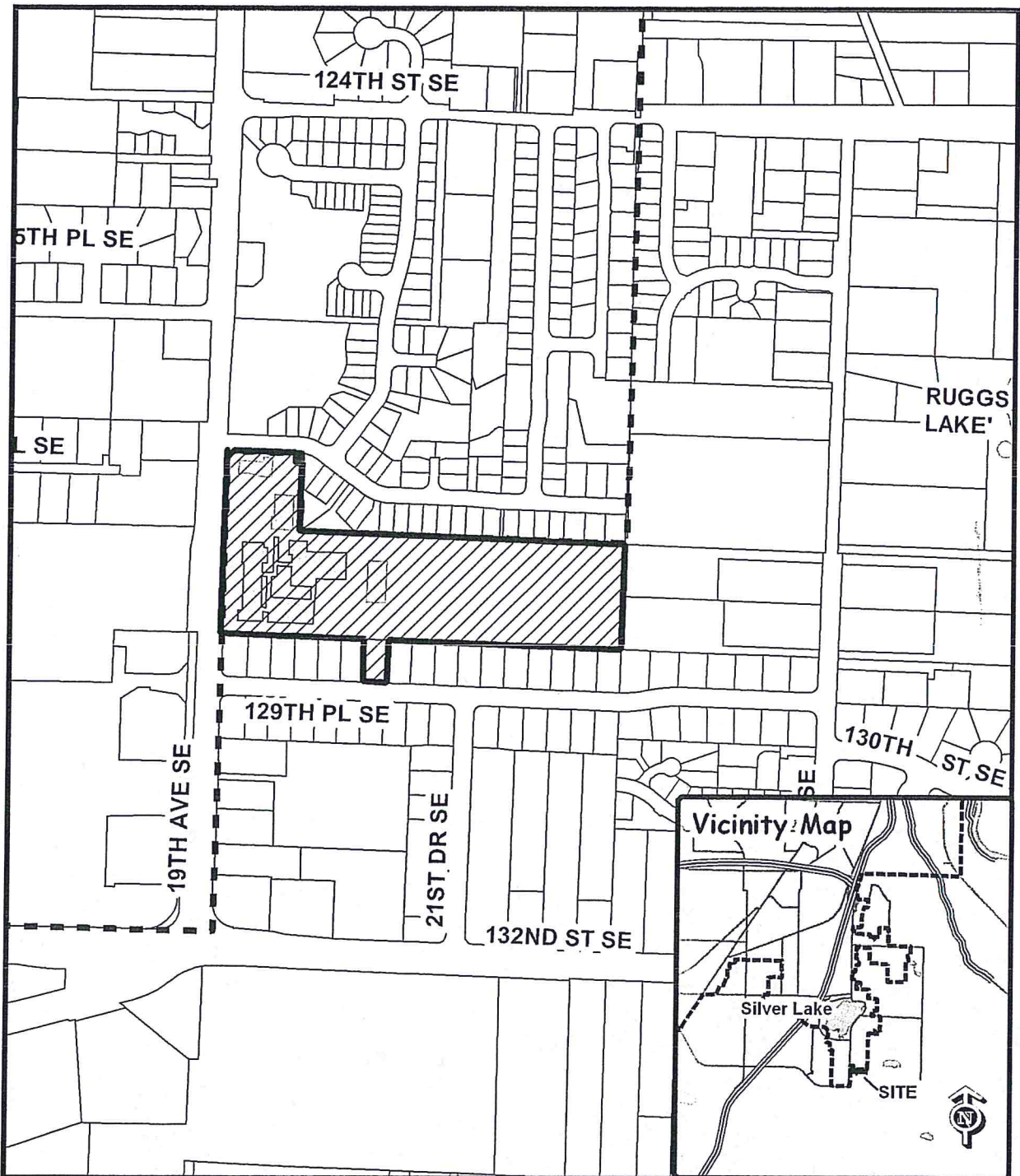

-  Annexation Area
11.1 Total Acres
-  Parcels
-  Everett City Limits

Silver Lake Elementary School Annexation



Scale: 1 inch = 500 feet
Dec. 2, 2005